

IMPRESSA XF50 Classic

Cleaning the machine

Approximate duration 15 min.

Equipment required:
 2-phase cleaning tablets
 Tub of 25 (Art. 62535)
 Pack of 6 (Art. 62715)



These short instructions do not replace the 'IMPRESSA XF50 Instructions for Use'. Make sure you read and observe the safety information and warnings first in order to avoid hazards.

Precondition: **READY / CLEAN**

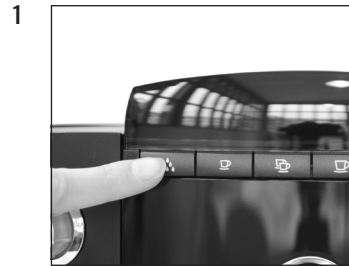

EMPTY TRAY

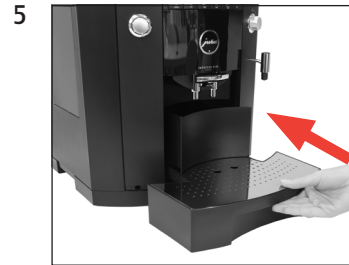
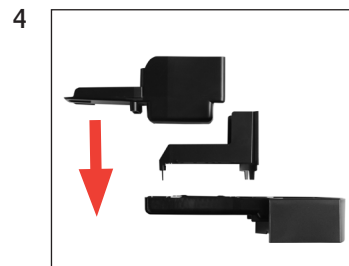

PRESS RINSE



**CLEANING
ADD TABLET**

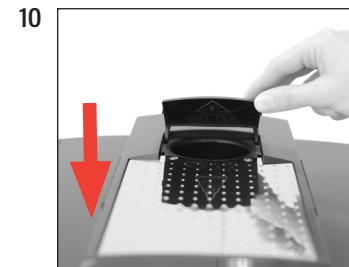
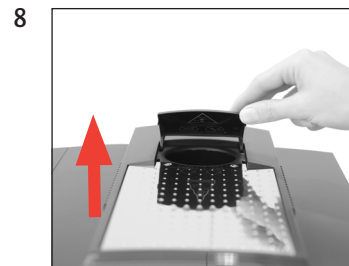

PRESS RINSE



**CLEANING
EMPTY TRAY**

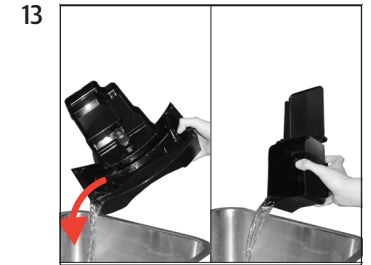

**HEATING
READY**